

eccentric fastening device at
the skidsDiamond device for
surface grinding

Layout SL-2

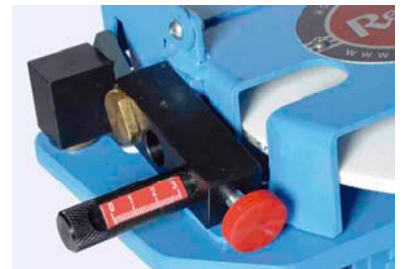
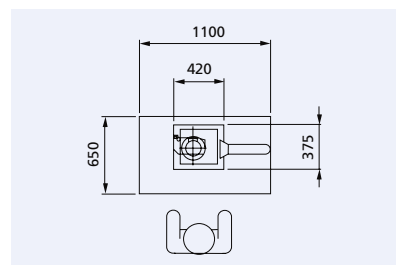

Perfect Performance for your Turns SL-2

The SL-2 skate grinding machine offers the perfect grind for the ice from hockey player to figure skater.

The excenter-tensioning device will fix every skid – independent from the type of skate. The tensioned skate will be bypassed at the grinding disc by the universal-poly-articulate arm and therefore in simplest way cut sharp as a razor. The SL-2 skate grinding machine encloses a disc stripping device for hollow and surface grinding including a dressing diamond. The integrated diamond stripping device shapes the grinding disc to the desired turning radius, so that you obtain flexible adjustable results.

The SL-2 has an optional dry or wet exhausting device that is within the machine stand. This frees the premises from sparks and grinding dust. For your safety and the safety of your coworkers we deliver SL-2 including a protection cover and safety goggles.

TECHNICAL DATA SL-2

Dimensions (L x W x H) in mm	
table design without exhausting device	460 x 600 x 500
Stand design with exhausting device	460 x 600 x 1300
Weight in kg	20
Connecting voltage	400 V, 3 PH/N/PE, 50 Hz
Connecting plug	CEE 16A 5-pol.
Connecting power in kW	0,25 (0,47)

ACCESSORIES SL-2

Description	Article number	Page
Dresser	750312	28
Tuning wheel Ø200 x 6 x 51, K80J	400934	29
Tuning wheel Ø200 x 6 x 51, K100J	1011271	29